

ELEVATOR COMMUNICATION SYSTEM

ReMic for Lift Watch *GSM/IP*



Installation Guide v1.0

The device is designed for emergency voice communication of the elevator cabin with the emergency service, firefighters, police, operators, etc. The device meets the requirements of EN 81-28+AC:2019-04 and EN 81-70.

Basic technical parameters:

Inputs 2x – 1x call blocking, 1x universal
Outputs signal. LEDs or bulbs 12V (24V) max. 100 mA
ReMic Module A/L1 110 x 78 x 38 mm (without handles)
ReMicAS1 module 135 x 66 x 22 mm
ReMicL-AV Module 110 x 220 x 30 mm

Basic features:

- No telephone line needed at the point of use
- Possibility of audio units for the cabin, shaft and machine room (ReMicA1, ReMicAS1, ReMicL1, ReMicB, ReMicL-AV + PREPOJ) – simultaneous connection of all units with the control room/ connection only of the machine room with the sound systems in the shaft and cabin.
- indication of the established, ongoing connection and other states of the device by switches for optical signaling or LED directly on the device (ReMicB, ReMic-AV)

	Indications according to the ReMic used	
Status	Current indications (ReMicA, ReMicB, ReMicL)	Indications according to EN 81-28:2018 (ReMicA(S)1, ReMicL1)
Initialize a connection	Fastened I1 (yellow)	Fastened I1 (yellow)
Connection established	Switched I2 (green)	I1 and I2 (yellow and green lit)
Connection terminated	I2 unzipped	I2 is opened, I1 remains switched on until the end of the EMERGENCY state (ALARM). *

Communication Base Terminal Block for ReMic (SRGM)

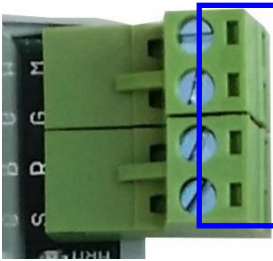

Terminals for connection to the ReMic module in the elevator – the same marked terminals are connected
 M – microphone
 G – ground
 R – Speaker

ReMicA1 Speaker Module Terminal Block (ReMic)

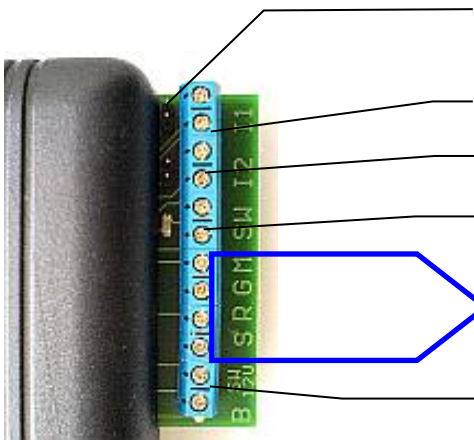

- Jumpers current limitation switches (see wiring examples)
- I1 indicator switch terminals
- I2 indicator switch terminals
- Call Activation Button Clamps
- Terminals for connection to the base unit – the same marked terminals are connected (see
- Insulated terminals for call activation by applying voltage

ReMicL1 speaker module terminal block

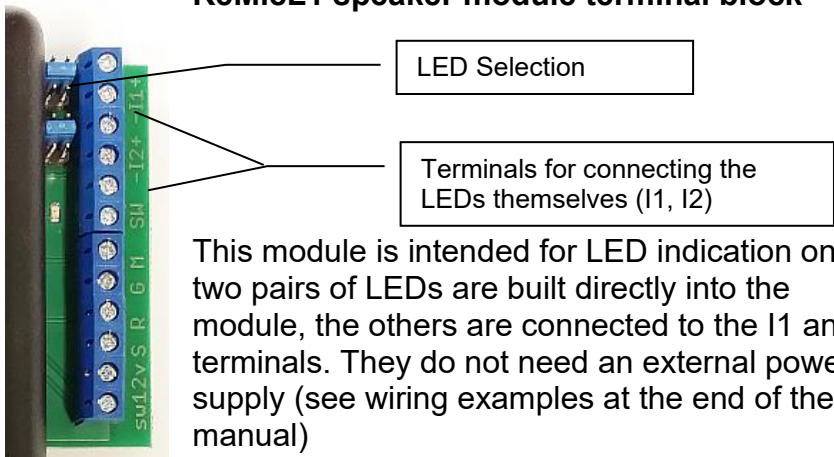

ReMicAS1 Speaker Module Terminal Block

The module is a variant of the ReMicA1 designed for low panel installation (height 22 mm)

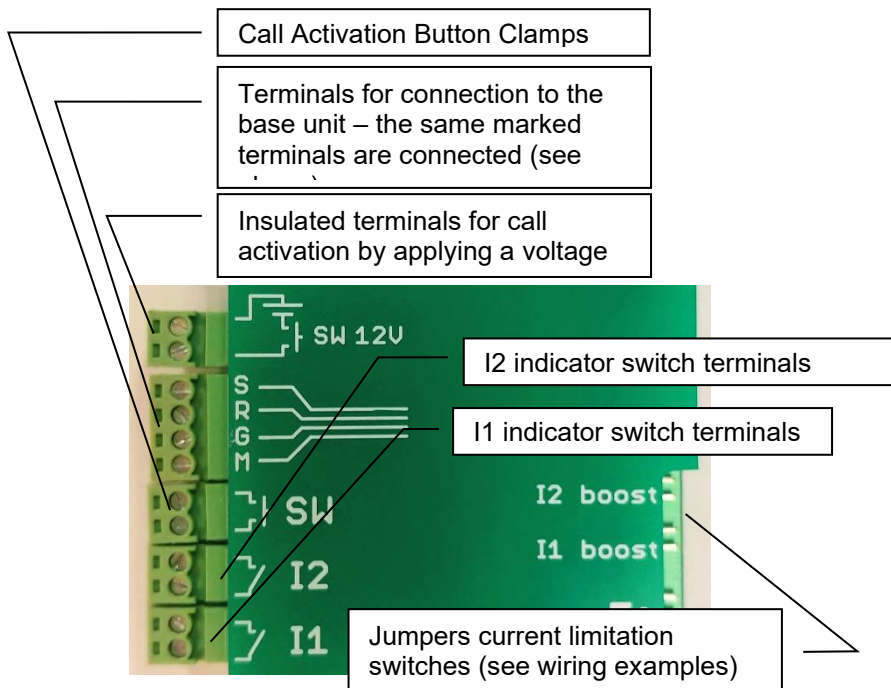

ReMicL-AV Speaker Module Terminal Block

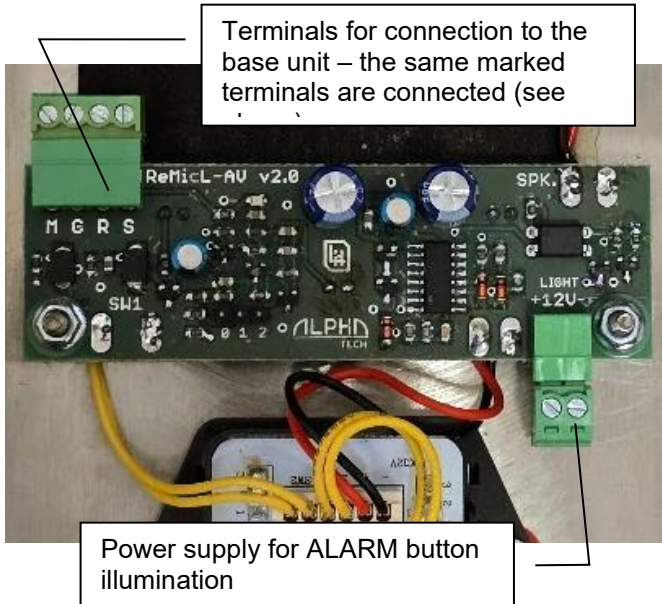

ReMicB speaker module terminal block

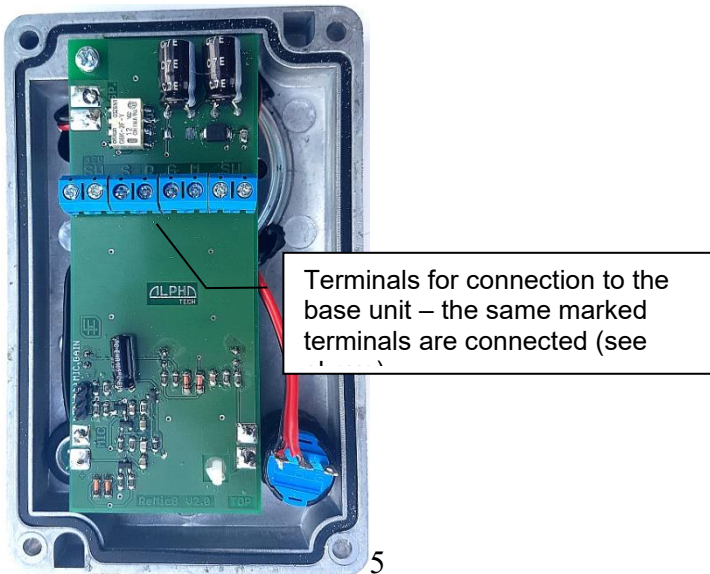

Installation:

- Attach the speaker module (ReMicA(S)/L1) to the **grille** on the panels in the elevator cars. For good audibility, especially of the call from the cabin, we recommend placing it at head height. **There must be a hole in the grille in front of the microphone, otherwise the audibility of the call from the booth will be poor!**

ReMicA/L1

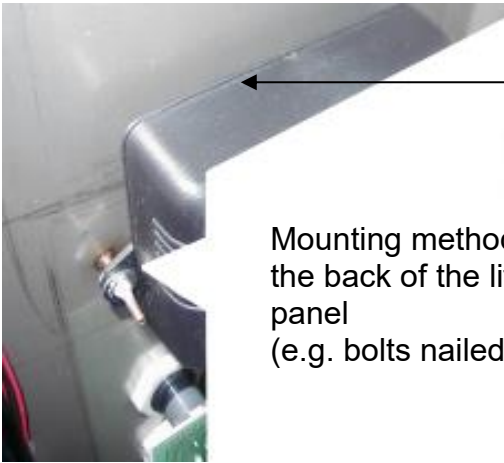

speaker and microphone is facing the panel

Mounting method on the back of the lift panel (e.g. bolts nailed)

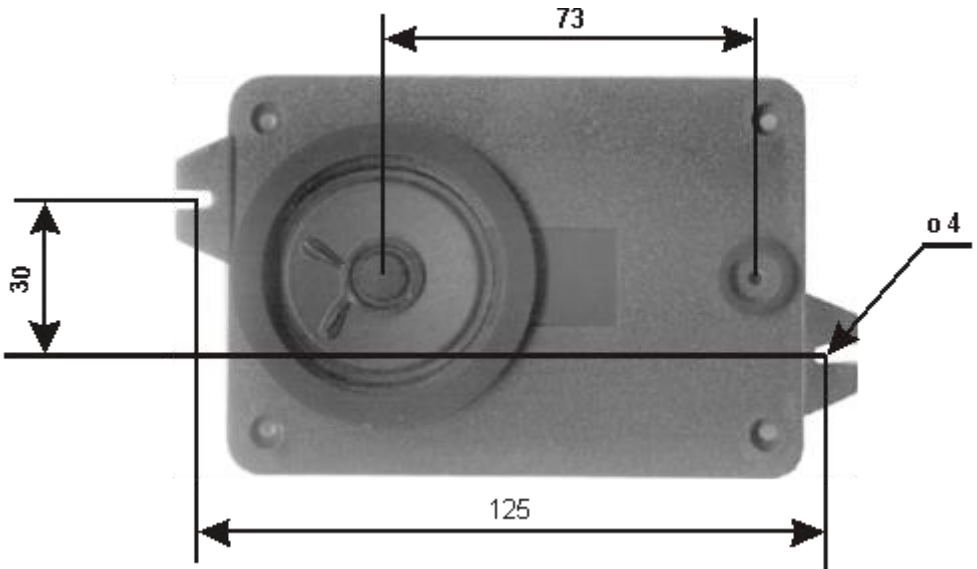

ReMicAS1

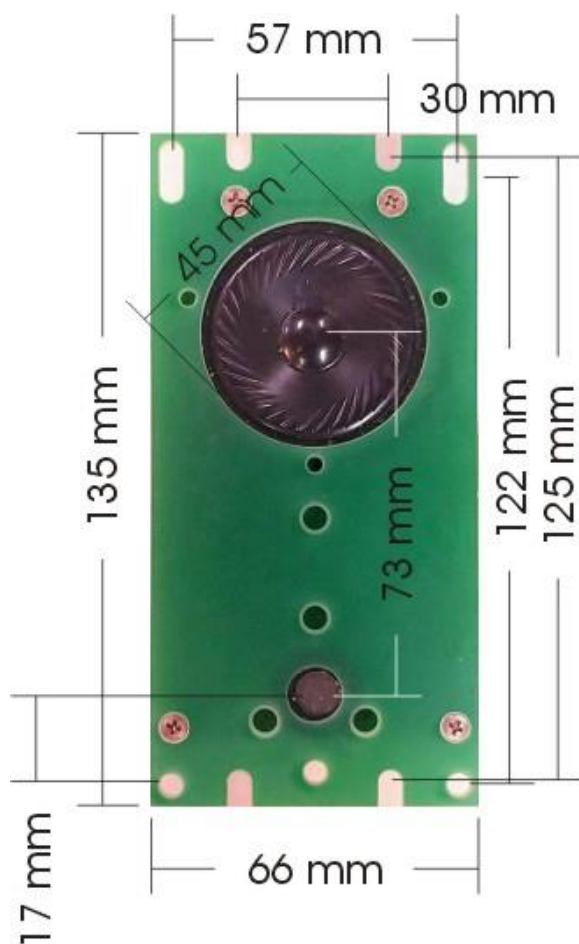

ReMicL-AV

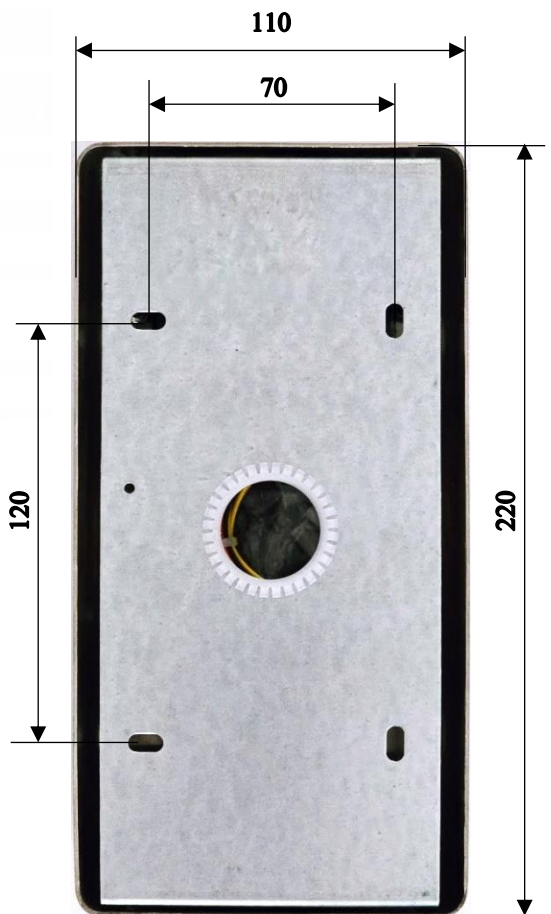

ReMicB

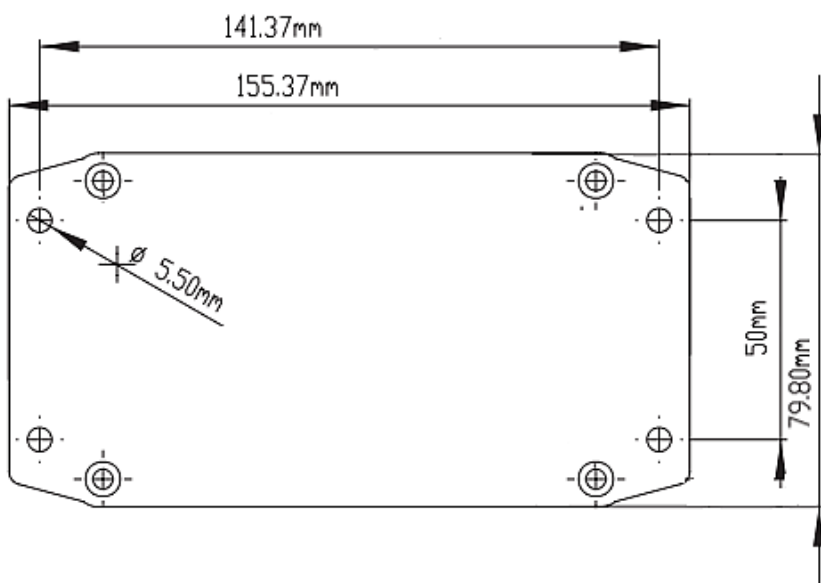

Easiest wiring with ReMicA1 without optical signaling

Signaling in the cabin only by voice, power supply from the elevator system.

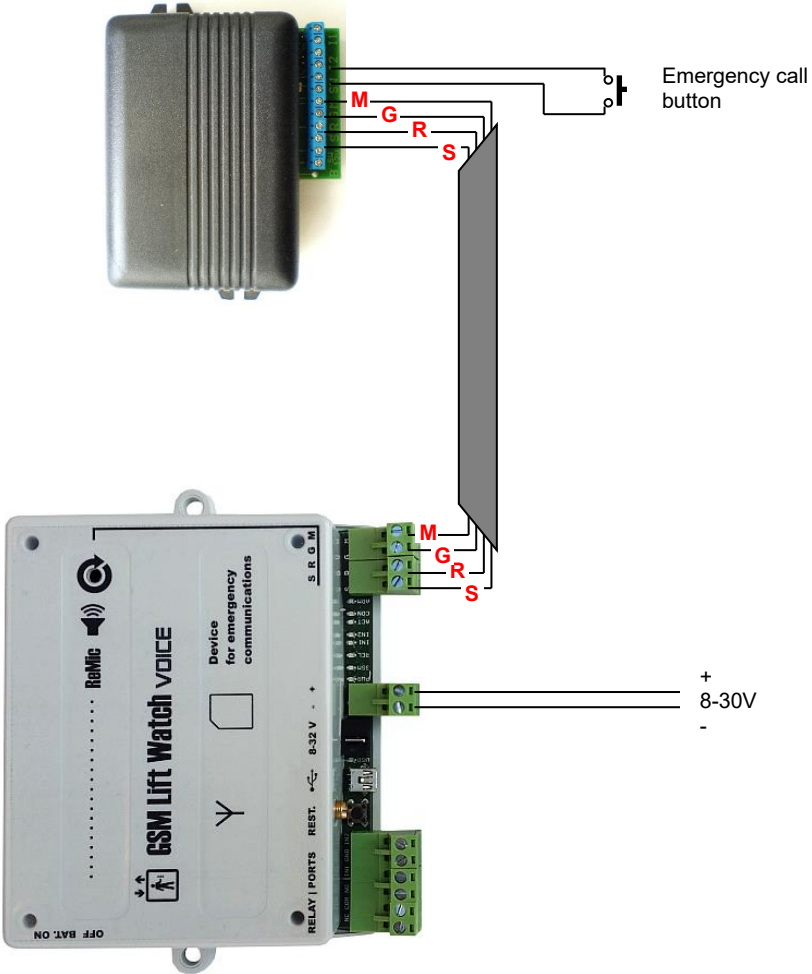

Easiest wiring with ReMicAS1 without optical signaling

The wiring is the same as on the previous page. Since it is completely identical, the other examples that will be for ReMicA1 are also true for ReMicAS1.

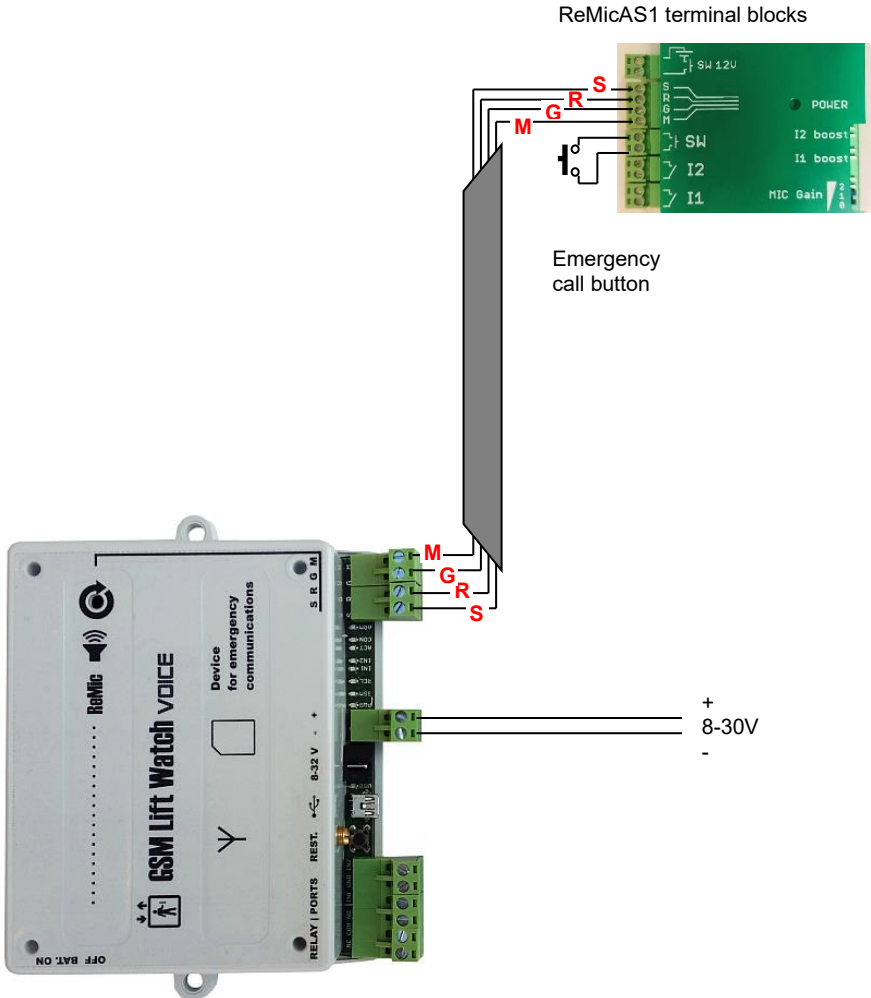

Easiest wiring with ReMicL-AV with built-in optical signaling

The ReMicL-AV has a built-in button for activating the alarm and a signaling LED with appropriate pictograms according to the standard.

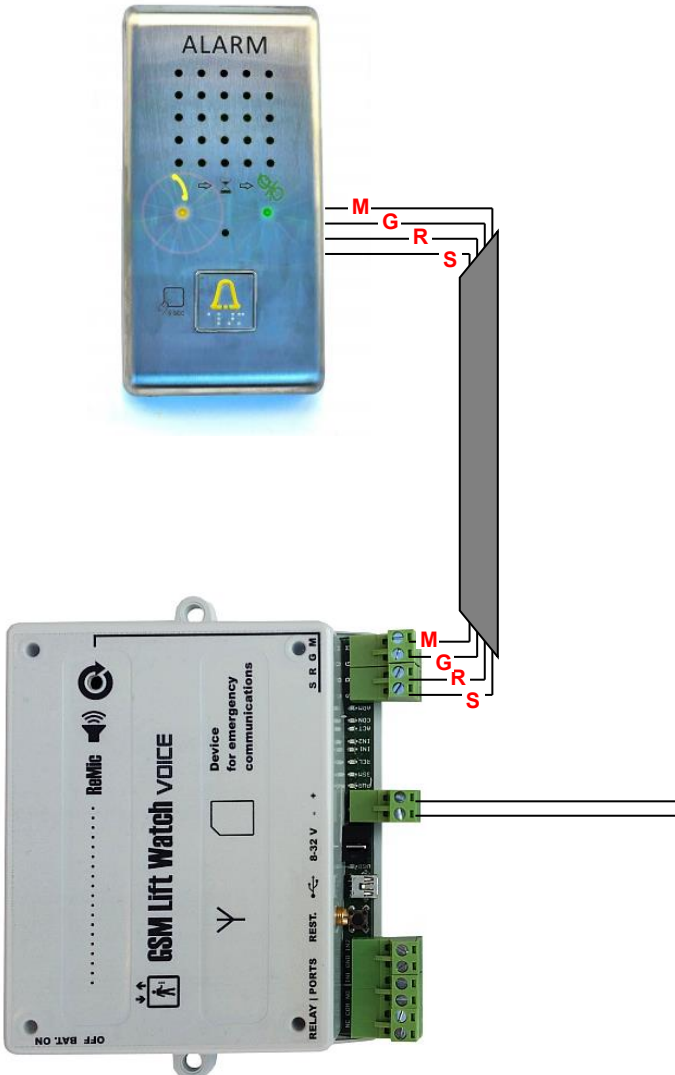

Basic wiring with ReMicA1 and signal bulbs

Power supply from the elevator system

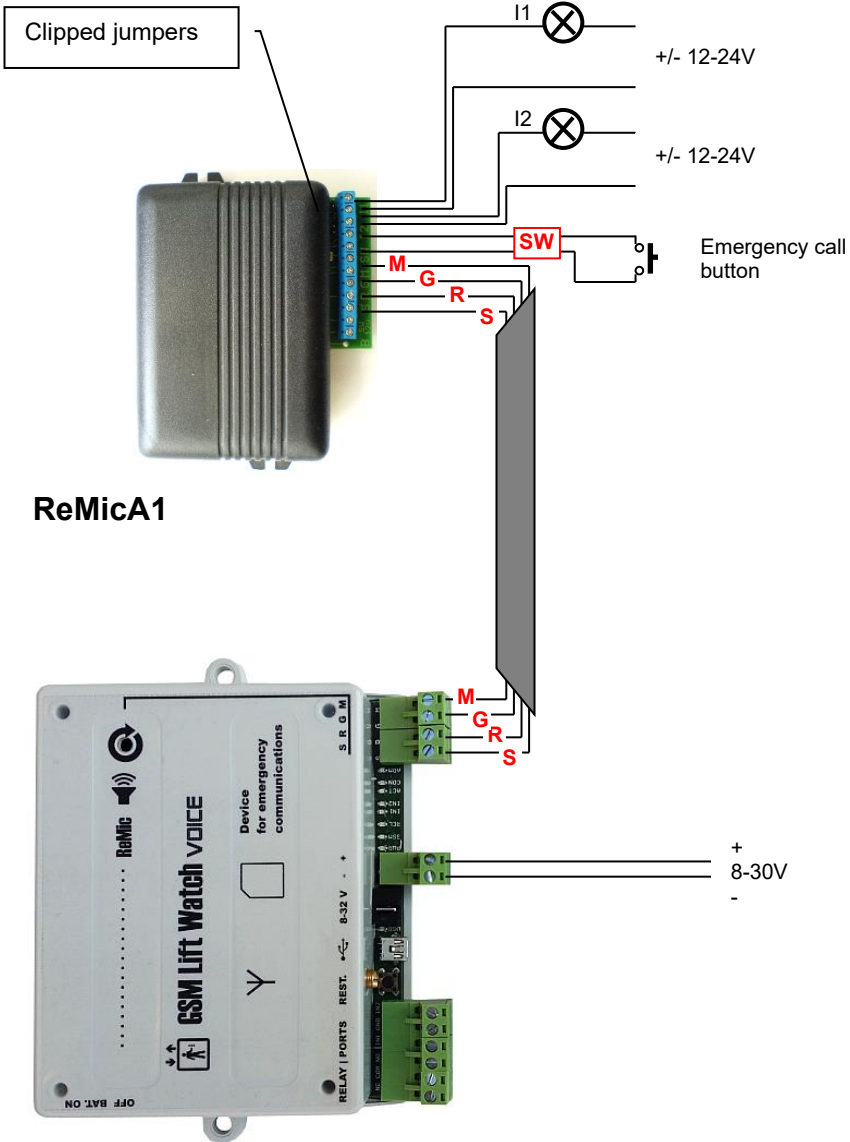

Basic wiring with ReMicA1 and signaling LEDs

Power supply from the elevator system

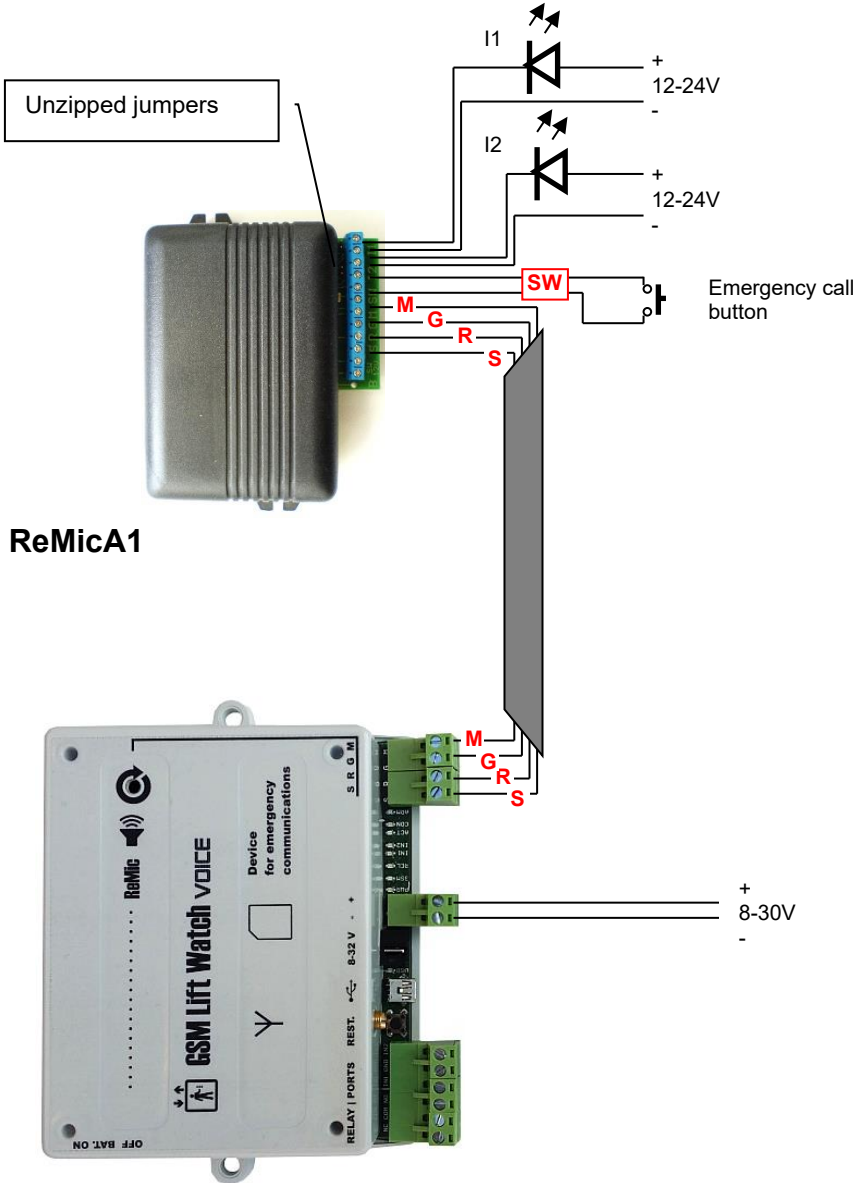

Basic wiring with ReMicA1 and signaling control by logic inputs panel in the cabin (against the ground)
 Power supply from the elevator system

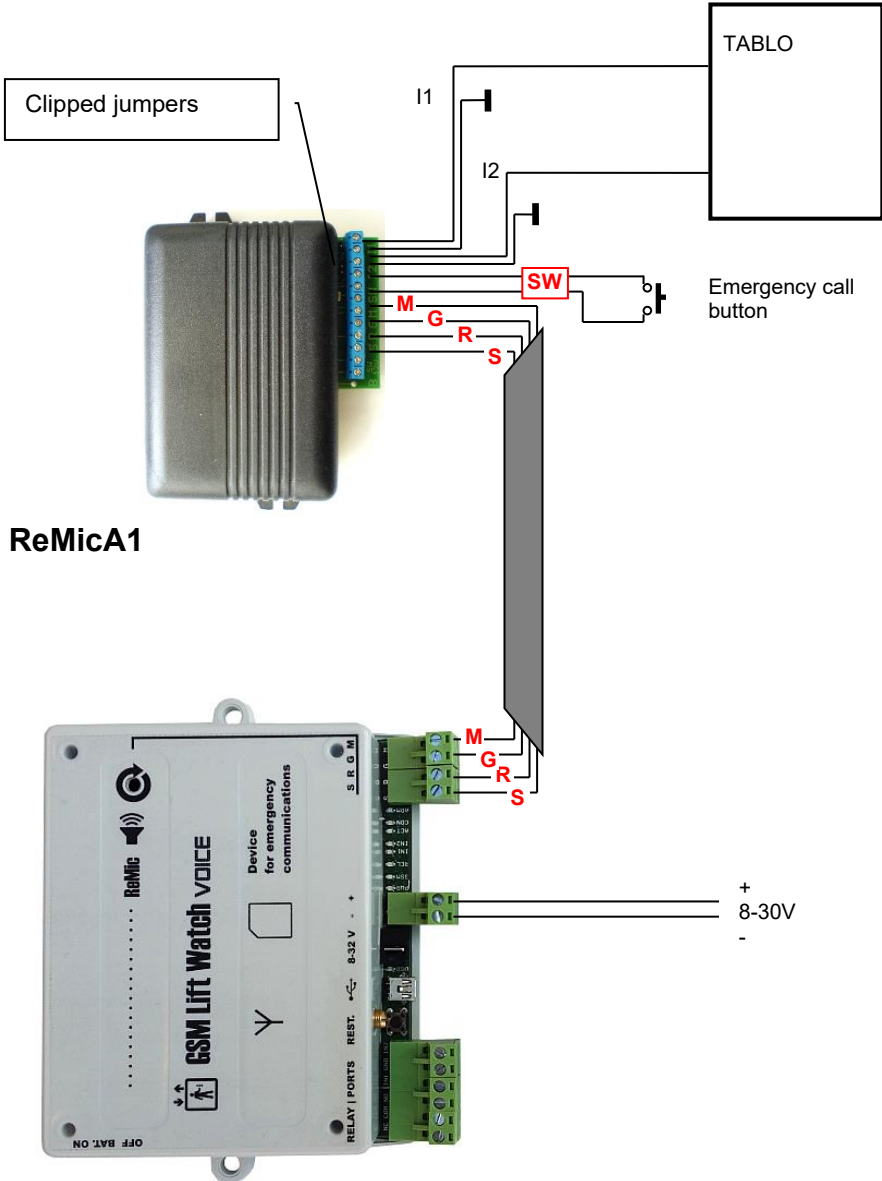

Basic wiring with ReMicL1 and signaling LEDs powered by the elevator system (ReMicL1 is only designed for direct LED connection)

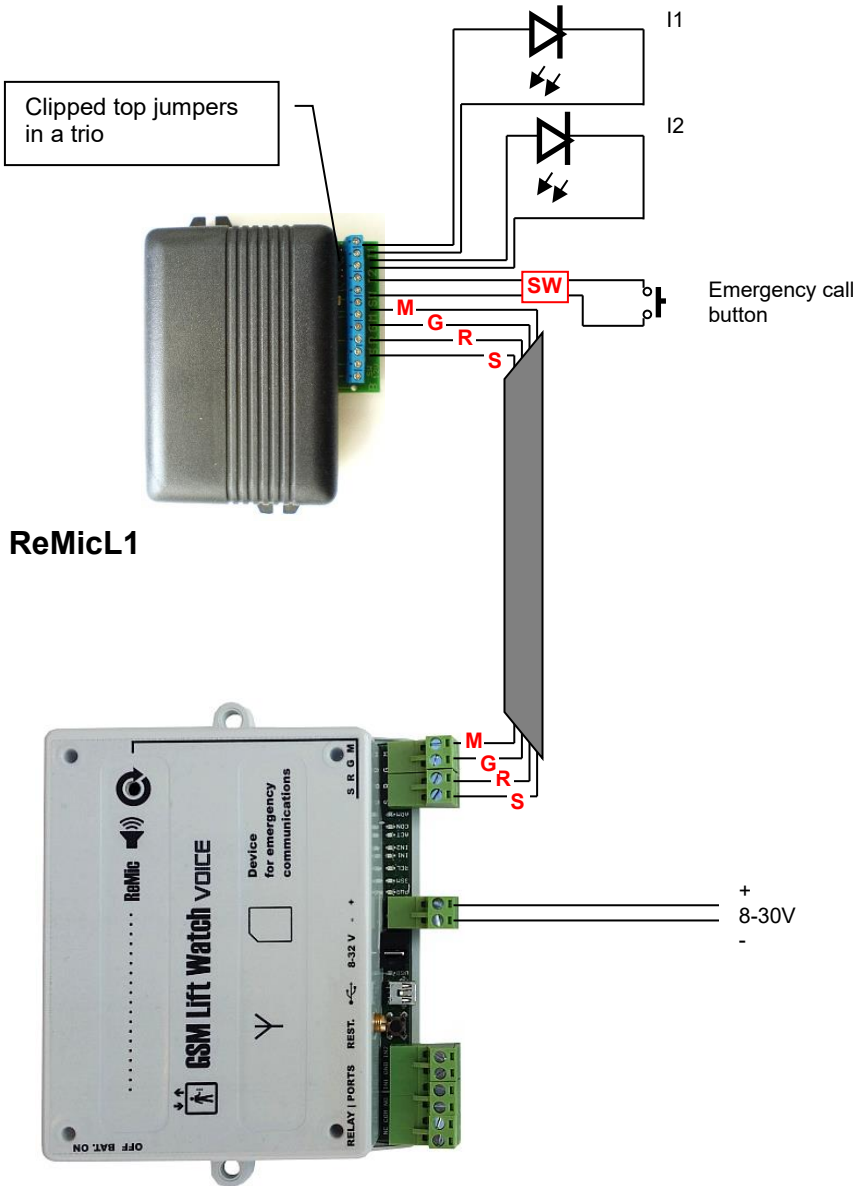

Example of wiring for communication with the machine room (PREPOJ)

Cabin Communication

ReMicA1
 ReMicL1
 ReMicAS1
 ReMicL-AV

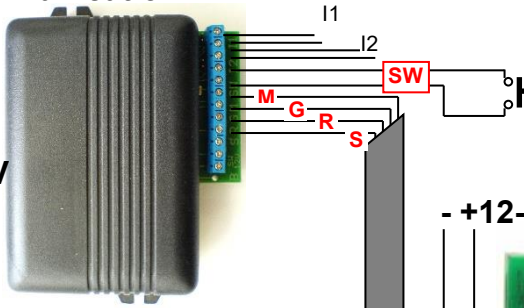

+12-24V



PREPOJ

Communication in the machine room



+
 8-30V
 -

Example of wiring for communication with the cabin, shaft and machine room (up to 3 ReMics can be connected together)

Cabin Communication

ReMicA1
ReMicL1
ReMicAS1
ReMicL-AV

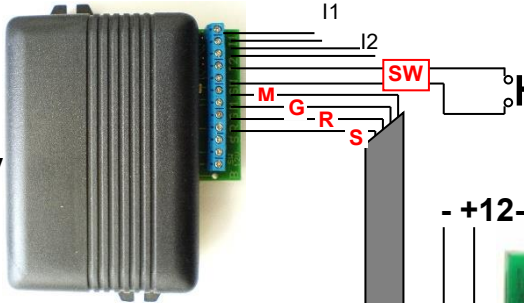

Communication in the shaft - 2x ReMicB

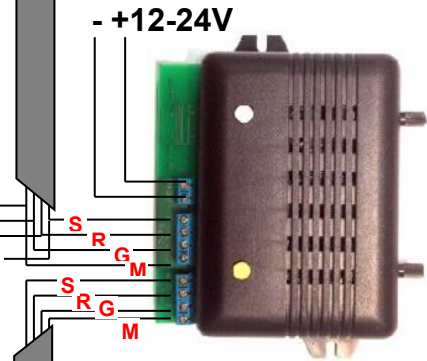

PREPOJ

Communication in the machine room

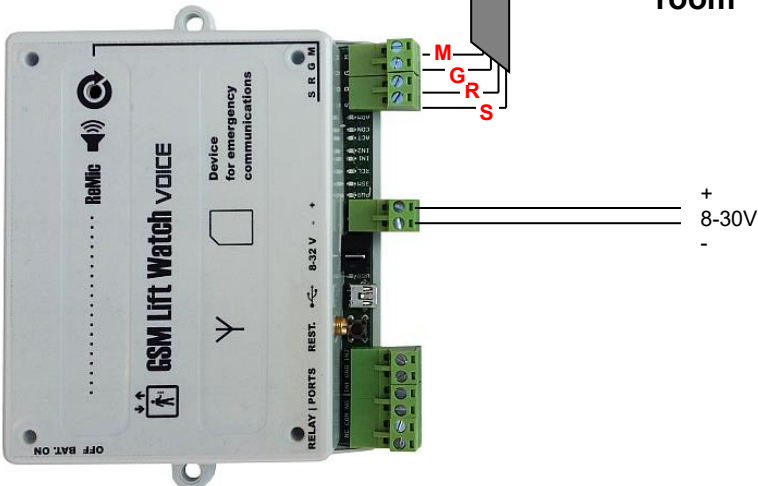

Example of activation wiring using galvanically isolated terminals of a 12V ReMicA(S)(L)1 switch – connection to a doorbell or siren.

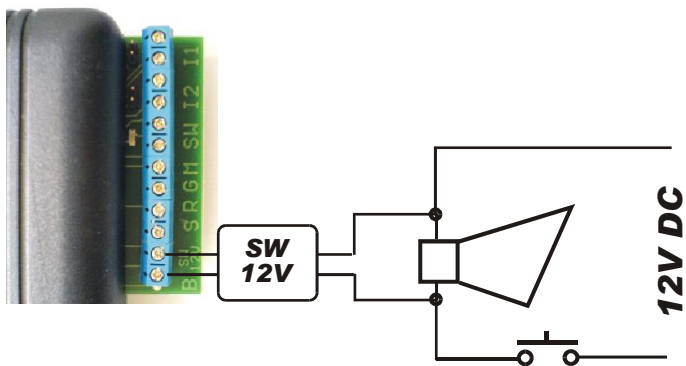



Alphatech spol. s r.o.

Jeremenkova 88

140 00 Prague 4 - CZ

tel. +420 244 461 072

E-mail: info@alphatech.cz

Internet: www.alphatech.cz

our GPS coordinates (WGS 84)

N 50°02'35.5" E 14°25'42.0"

9.3.2026